

SOUTH SIDE ELEVATION

CONSTRUCTION APPROVED THE PLAN AND WORKING DRAWINGS FOR THE PROPOSED BUILDING. THE CLIENTS OF FOUNDATION & ROOF CASTING OF BUILDING ATTACHED.

Passed in the Public Meeting held on 28-11-19

Passed in the Board Meeting held on 28-11-19

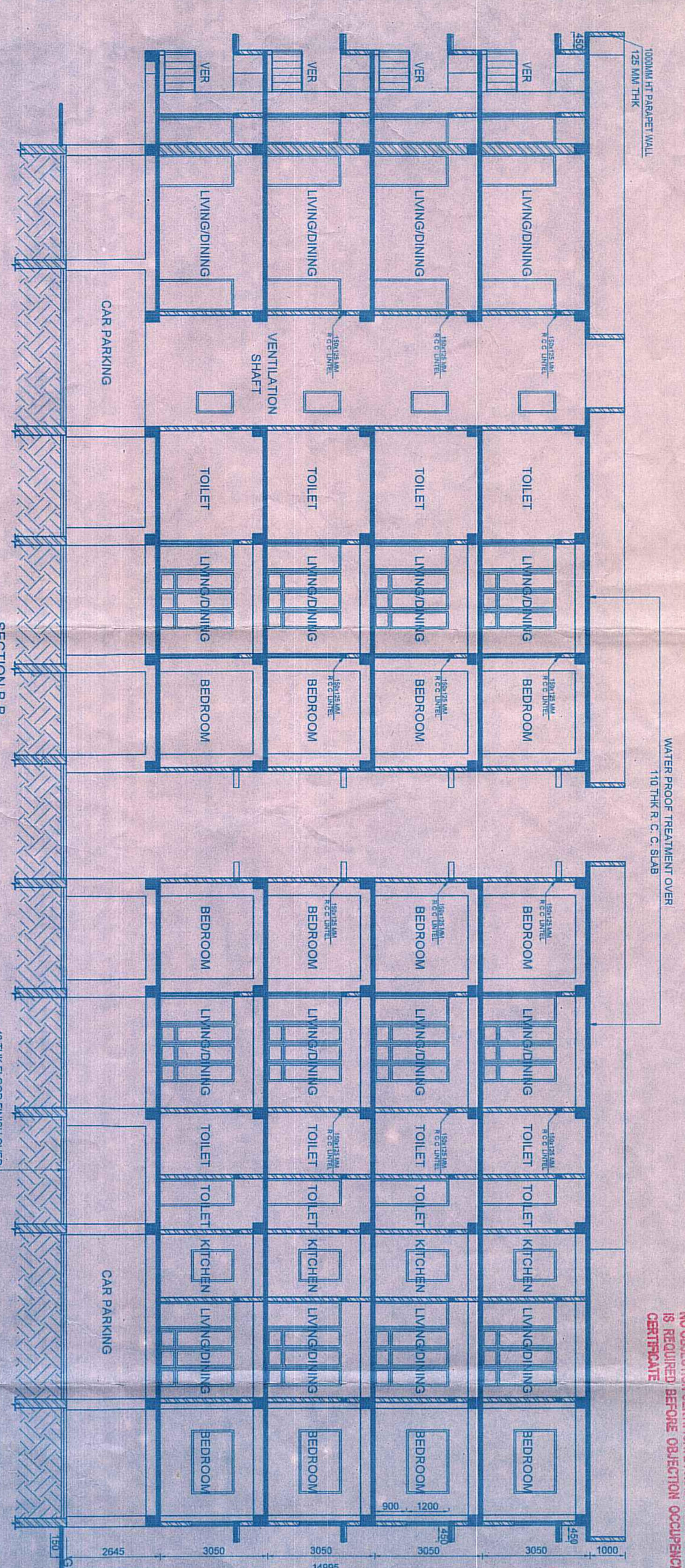

SECTION B-B

SECTION A-A

THIS PLAN IS CONDITIONALLY SANCTIONED THAT NO OBJECTION CERTIFICATE FROM THE SERVICE IS REQUIRED BEFORE CONSTRUCTION COMMENCEMENT.

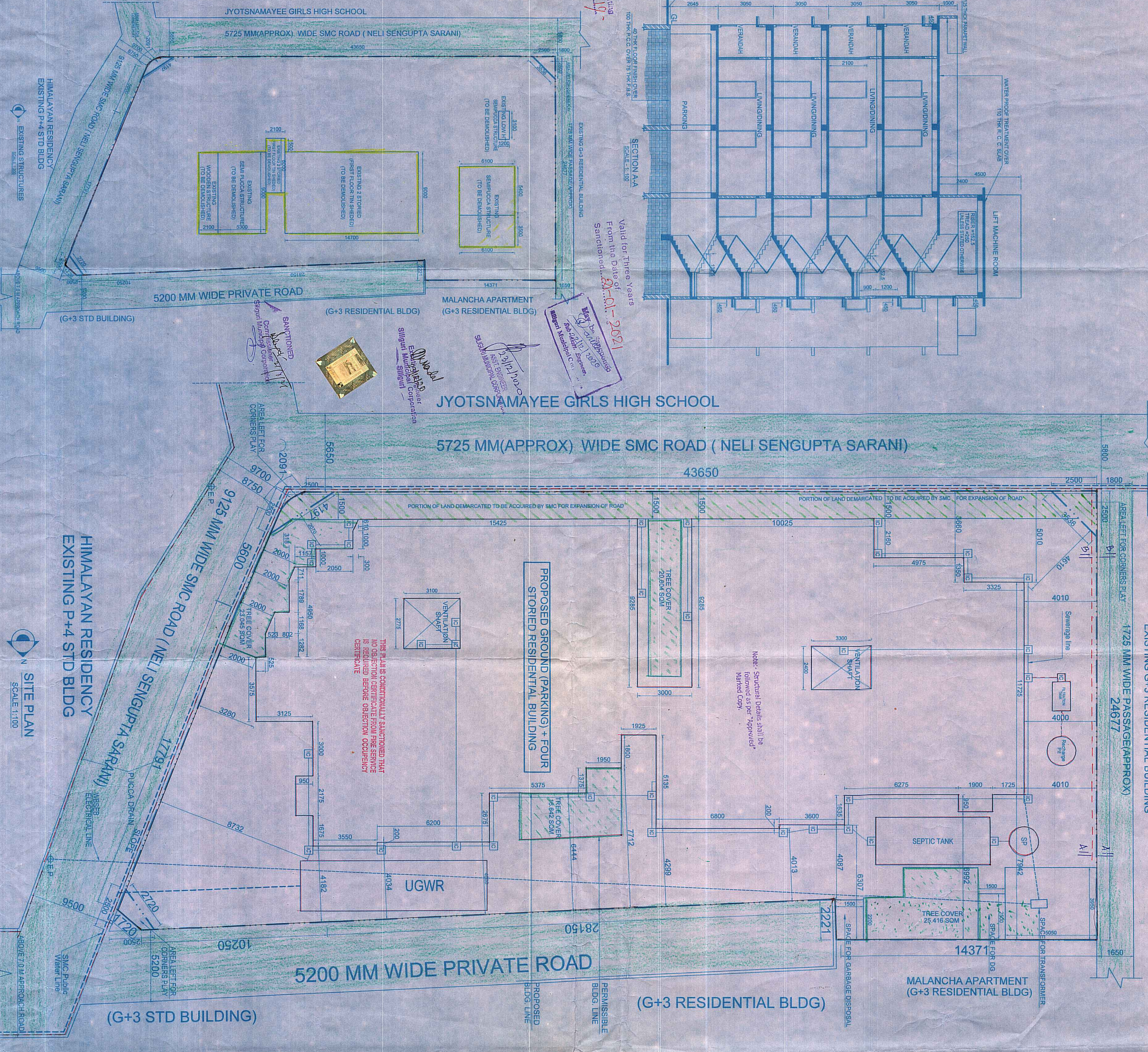

SITE PLAN  
SCALE: 1:100

**DECLARATION BY OWNER & ARCHITECT**

I/We do hereby declare that the information furnished in this application is true and correct and that the proposed building is in accordance with the provisions of the Building Act, 1988 and the Building Rules, 1989. I/We do hereby declare that the proposed building is in accordance with the provisions of the Building Act, 1988 and the Building Rules, 1989. I/We do hereby declare that the proposed building is in accordance with the provisions of the Building Act, 1988 and the Building Rules, 1989.

**POWER OF ATTORNEY**

**NAME OF OWNER (S) :**

1. SRI PRADIP RAY SARKAR
2. SRI BANANI CHATTERJEE
3. SRI BANANI CHATTERJEE
4. SRI BANANI CHATTERJEE

**PROPOSED BUILDING:**

1. SRI PRADIP RAY SARKAR

**PROPOSED BUILDING:**

1. SRI BANANI CHATTERJEE

2. SRI BANANI CHATTERJEE

3. SRI BANANI CHATTERJEE

4. SRI BANANI CHATTERJEE

**LAND SCHEDULE**

Plot No. 2221

Area: 14371 sq. m.

**PERMISSIBLE BUILDING:**

1. G+3 Residential Building

**KEY PLAN**

Scale: 1:1000

Location: Jyotsnamayee Girls High School, Malancha Apartment, Himalayan Residency.